

AVC-BA92SVT(-W)

HD TVI / EX SDI & HD SDI / ANALOG



AIB-IR™ (Auto Intensity & Brightness)

Equipped with eight AIB-IR™ Auto Intensity & Brightness control, this feature not only has Smart IR™ control (brightness), but also it controls the IR intensity depends on focal length of the variable lens. This will prevent over exposure of IR light on the images and IR halo effects commonly seen on conventional IR cameras.



Optional 5-50mm Megapixel Lens

Optional 5-50mm Megapixel Lens allow users to install on wide variety areas and environment.

External Lens Adjustment & Service Out

External Lens Adjustment and Service Output Port makes installation much easier than conventional weatherproof cameras.

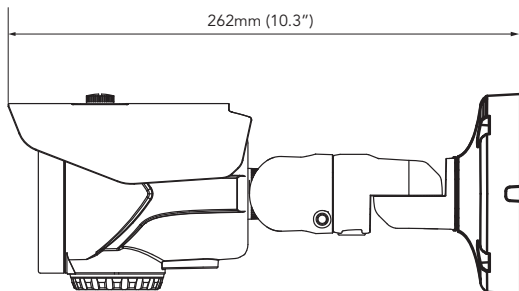
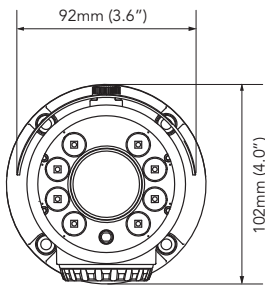

Unit : mm (inch)



Heater & Thermostat Module

Camera has on-board heater & thermostat module which allows continuous operation on temperature -40°F



Optional IDP™ Isolation Dual Power

Our patent pending IDP™ Isolation power will provide power to the camera more efficiently and safely by protecting the camera from surge, ground noise, and etc.
(Available on DC 12V/24VAC models only)

Patent Design 5-Axis Bracket

5-Axis bracket will make installation much easier. This patented bracket can be pointing angel past 180°. Even roof top mounting is possible with this bullet camera

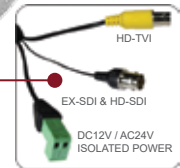

Dual HD Video Output

Both EX-SDI/HD-SDI and HD-TVI output provide Full HD @ 30fps real-time video simultaneously. This feature allows to connect up to 2 High Definition DVR's or 1 High Definition DVR and 1 Live High Definition TV/Monitor at the same time.

DESCRIPTION	AVC-BA92SVT(-W)
Image Sensor	1/2.9" 2.4 Megapixel Sony Exmor CMOS
Image Resolution	1920 x 1080
Scanning System	Progressive
Video Output	HD-TVI, EX-SDI / HD-SDI, CVBS (OSD Selectable)
S/N Ratio	More than 52dB
Min. Illumination	0.02Lux (Sens-up x32)
Iris Adjustment	ALC / ELC
Lens	2.8 ~ 12mm MP DC Auto Iris Varifocal Lens (ICR)
Electronic Shutter	Auto (1/30 ~ 1/60,000) Auto (1/25 ~ 1/60,000) FLK
OSD Language	English / Chinese / Japanese / Korean
Backlight Compensation (BLC)	Off / HLC / BLC / WDR
Day & Night	Color / B/W / External / Auto
WDR	True WDR
Auto Gain Control (AGC)	Level (0 ~ 20) Adjustment
White Balance	Auto / Auto-EXT/ Preset / Manual
Privacy Masking	On / Off (Programmable 16 zones)
DNR	Off / Low / Middle / High
Smart IR (Anti-SAT)	Anti-SAT (0 ~ 20) Adjustment
LSC	On / Off
Gamma	0.45 / 0.5 / 0.55 / 0.6 / 0.65
Defog	On / Off
Digital Zoom	On / Off (x1 ~ x8.0)
Defect Correction	Live DPC (Dead Pixel Correction)
Sens-up	Off / x2 ~ x32
Motion Detection	4 Areas
Digital Effect	Off / V-Flip / Mirror / Rotate
RS-485	Yes, UTC (Up-the-Coax)
IR LED	AIB-IR™: 8pcs (250ft.*)
Input Voltage	DC 12V (±10%) / AC 24V - Dual Voltage
Power Consumption	DC IR Off: 210mA (Max.) / DC IR On: 650mA (Max.) AC IR Off: 200mA (Max.) / AC IR On: 550mA (Max.)
Operating Environment	-40°F ~ 140°F (-40°C ~ 60°C) / 10% ~ 90% Relative Humidity

*IR distance range varies depending on the environment

AVYCON®

☎ 949-752-7606 🌐 www.avycon.com ✉ info@avycon.com

Copyright © Avycon All Rights Reserved. Design and specifications are subject to change without notice.